

# L&L LOUVERS INC.

12355 DOHERTY STREET  
 RIVERSIDE, CA. 92503  
 (951) 735-9300 FAX:(951)735-4628  
 E-MAIL: info@louver1.com

# MODEL A-12-ACAF

FORMED ALUMINUM ACOUSTICAL LOUVER  
 12" Fixed Insulated Airfoil Blade 45° Blade

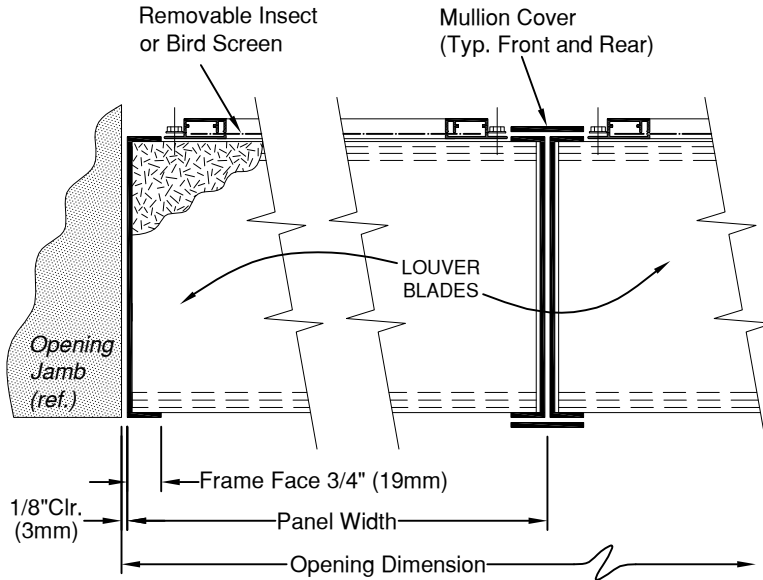

**TYPICAL HORIZONTAL SECTION**

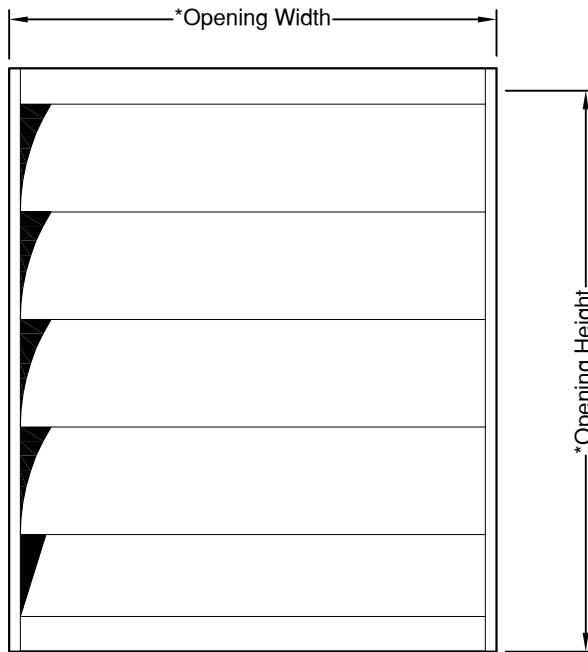

\*Actual net louver size will be 1/4" under Opening Dimensions.

**FRONT ELEVATION**

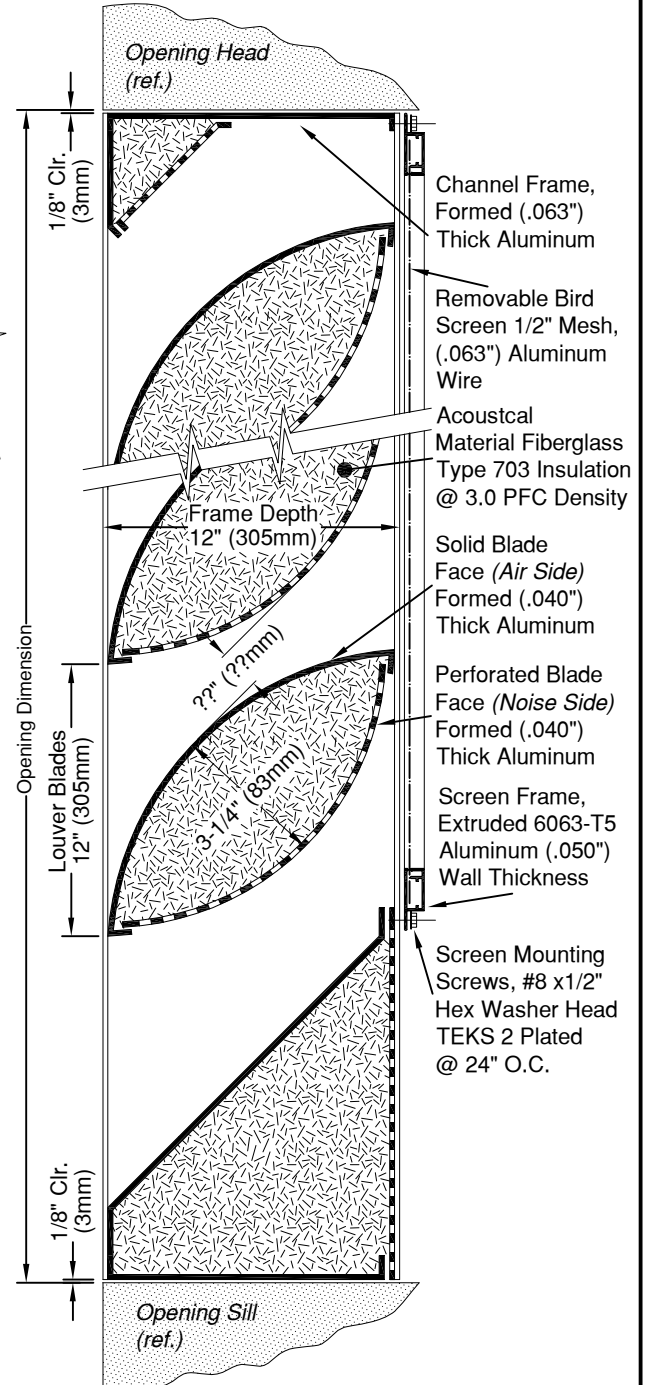

**TYPICAL VERTICAL SECTION**

PROJECT:	
LOCATION:	
ARCHITECT:	
CONTRACTOR:	
CUSTOMER:	
	DATE:



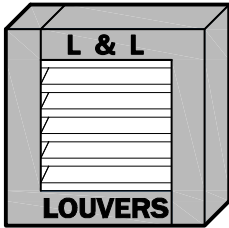

# L&L LOUVERS INC.

12355 DOHERTY STREET  
 RIVERSIDE, CA. 92503  
 (951) 735-9300 FAX:(951)735-4628  
 E-MAIL: info@louver1.com

# MODEL A-12-ACAF

Sound Transmission

## WESTERN ELECTRO - ACOUSTIC LABORATORY, INC.

1711 SIXTEENTH STREET SANTA MONICA, CALIFORNIA 90404 (213) 870-9268

PAUL S. VENEKLASEN / DIRECTOR (213) 450-1733

### INTRODUCTION

The methods and procedures used for this test conform to the provisions and requirements of ASTM Procedure E90-81, Standard for Laboratory Measurement of Airborne Sound Transmission Loss of Building Partitions. Details of the procedure will be furnished upon request.

### RESULTS OF THE MEASUREMENTS

The sound transmission loss values at 17 one-third octave bands are tabulated on the charts below. The Sound Transmission Class rating determined in accordance with ASTM E-413 was STC-10.

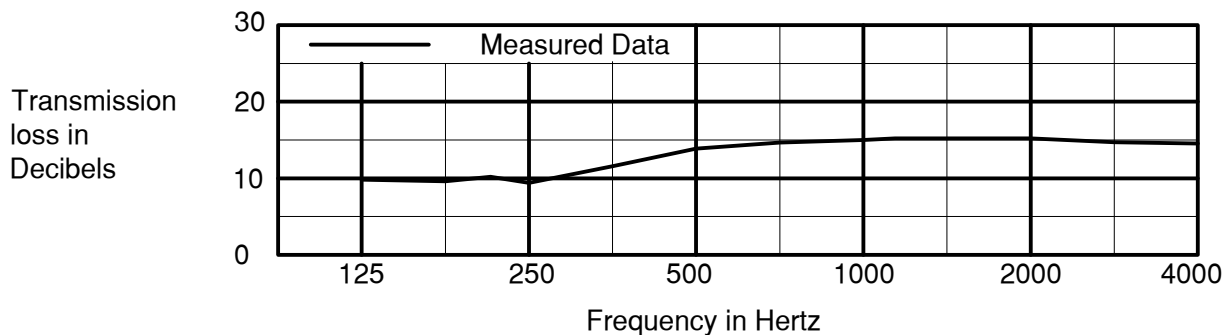

1/3 OCT BND CNTR FREQ	125	160	200	250	315	400	500	630	800
TL in dB	10	9	10	9	11	13	13	14	15
95% UNCERTAINTY IN dB	2.34	1.28	1.20	1.36	0.97	0.95	0.78	0.59	0.57
Speciman Area: 23.92 sq. ft.	1000	1250	1600	2000	2500	3150	4000	5000	STC
Temperature: 65 F	15	16	16	16	15	14	14	15	14
Relative Humidity: 54%	0.45	0.50	0.51	0.59	0.60	0.63	0.72	0.89	
Test Date: 14 Jan. 1992									

RESEARCH

CONSULTING

CALIBRATION

INSTRUMENTATION

ACCREDITED BY THE NATIONAL BUREAU OF STANDARDS, NATIONAL VOLUNTARY LABORATORY ACCREDITATION PROGRAM FOR SELECTED TEST METHODS FOR ACOUSTICS.